



quick start guide

SETTINGS FOR wBox DEVICES



app wBox



app wBox



TABLE OF CONTENTS

- | | |
|--|------|
| ▶ How to use wBox app | p. 2 |
| ▶ How to configure a new BleBox device | p. 4 |
| ▶ How to add configured BleBox device to another account | p. 7 |

for more information visit our website

www.blebox.eu

or send us an email to: info@blebox.eu
support is available at support@blebox.eu

proudly made by

blebox

>>>



1

At the launch of wBox app, it will ask you to log in or create an account.

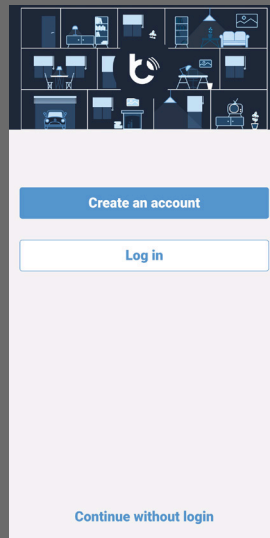

You can continue without login, but the features of the app will be limited. **We strongly recommend to create an account or log in.**

2

You can create the BleBox account or log in using your Google or Facebook account.

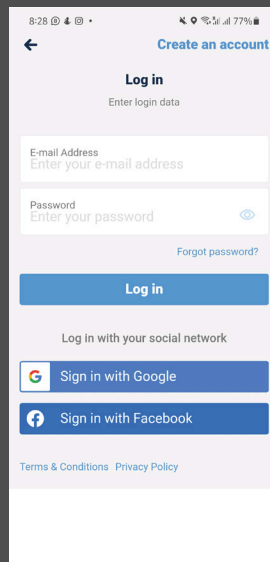



How to use wBox app - wBox app Tutorial

3

When you log in, a wBox app tutorial will automatically appear.

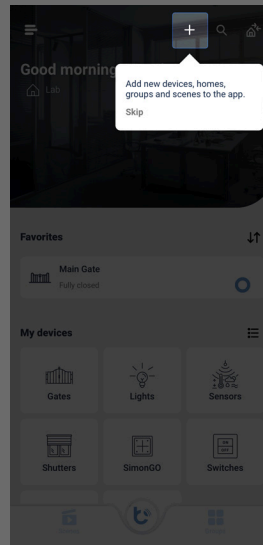

4

"If you do not see a tutorial, please click on 'menu' icon."

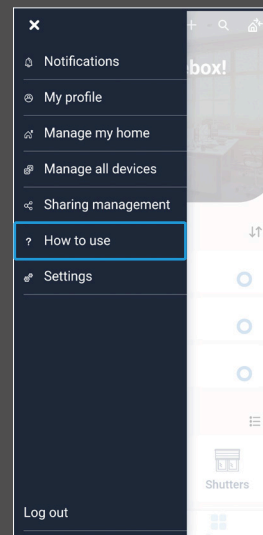
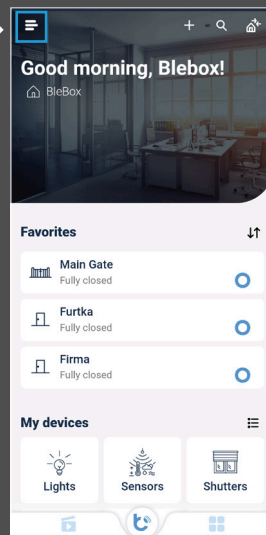

Tap on "How to use" to start the tutorial.



How to configure a new BleBox device - Tutorial, how to add a new device

5

> Add new device

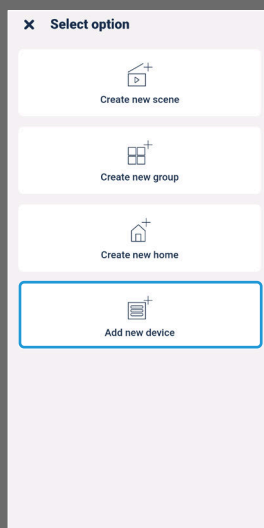
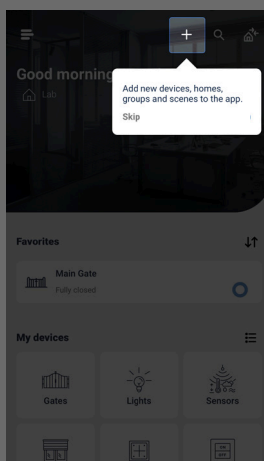

Tap on "Add and set up a new device".

Step (0/12)

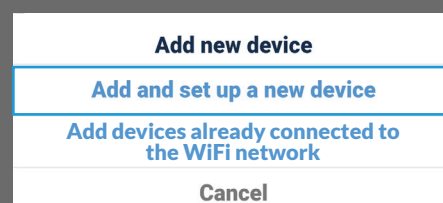



How to configure a new BleBox device - Connect phone to WiFi Access Point of the controller

6

✕ Add and set up a new device

- 1 Use the settings app of your phone to connect to the WiFi network emitted by your new device. Make sure that mobile data are off.



- 2 Wait until network scan ends.

- 3 Choose the WiFi network (the name consists of your device type and ID).



- 4 Connected! Some phones may report that "Internet may not be available" - it's normal.

- 5 Open the wBox app. You will see the "Directly connected devices" section.

- 6 Press the "Add device to account" to add the device to your app.

Direct connection was established to the WiFi network emitted by the device

Shutterbox

+ Add device to account

Use only once

With a direct connection, you can use the device only once or add the device to the application using the plus button.

- 7 To return to normal application mode, you just need to disconnect from WiFi network emitted by your new device and reconnect to your wifi network. The device you just added will be available on your wBox account.

It is recommended to set a password for the WiFi network broadcast by the new device - this option is available in the section "Access Point" in your new device settings.

Please follow the instructions displayed on the screen.

> iOS version



> Android version

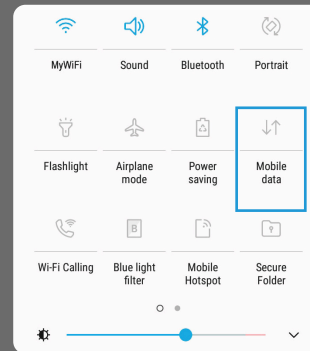

Please turn off mobile network / cellular data in your phone.

Step (1/12)

> Android version

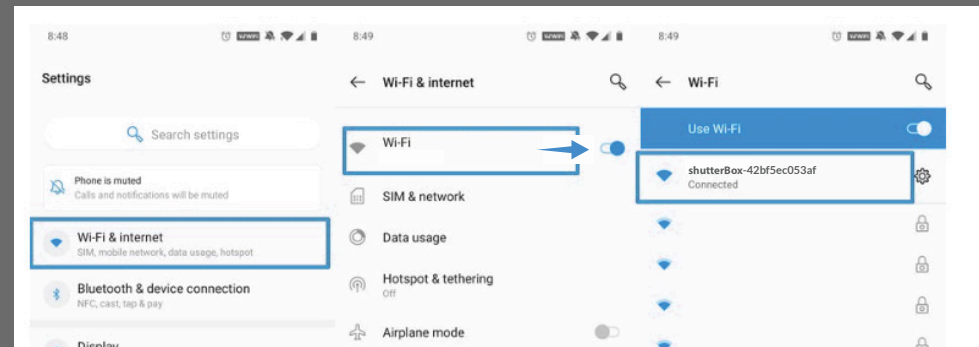

Please select WiFi settings in your phone and turn on WiFi network.

Step (2/12)

Please connect with controller's WiFi network (its AP) that should be named e.g: "shutterBox-42bf5ec053af".

Step (3/12)

Connected! Some phones may report that "Internet may not be available" - it's normal, please continue with this WiFi network.

Step (4/12)

> iOS version

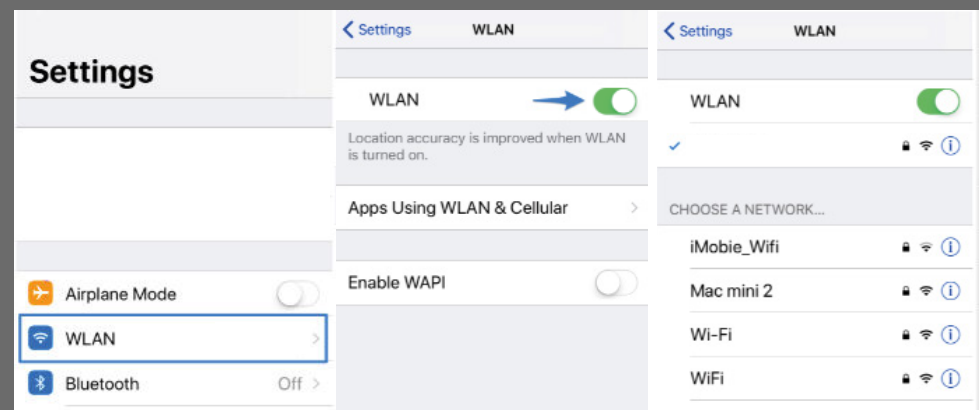



How to configure a new BleBox device - Configure a new BleBox device

7

After connect to the WiFi network of the BleBox controller, return to wBox app and go to the dashboard by click on "X" of the manual.

Step (5/12)



Add and set up a new device

1

Use the settings app of your phone to connect to the WiFi

8

Please use "+ Add device to account" button to add the device to your account. Now you became the owner of the device.

Step (6/12)

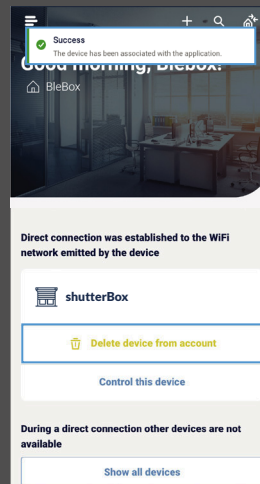
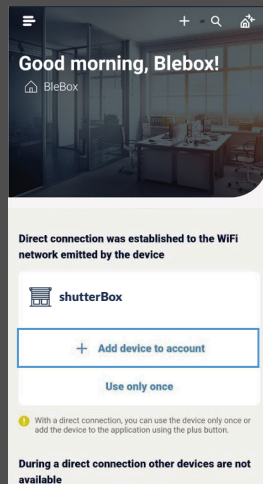

Success! You added device to your account.

Step (7/12)

9

Select 'Control this device' and follow to Connection settings as shown.

Step (8/12)

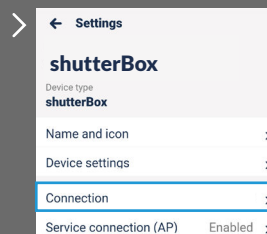
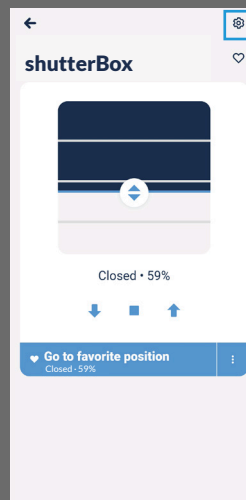
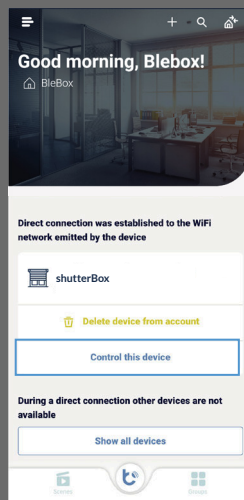

Select your home WiFi network from the list and connect to it.

Step (9/12)

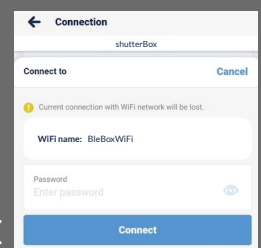
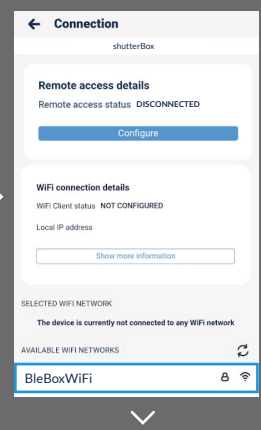

"Great! - WiFi Client status: connected! The BleBox controller is connected to your home network.

Step (10/12)

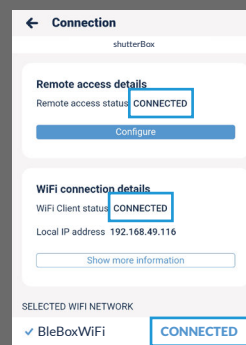



How to configure a new BleBox device - Turn off or set password to BleBox AP

10

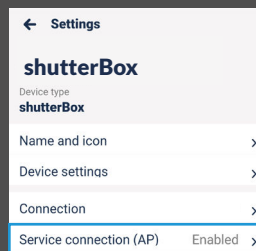
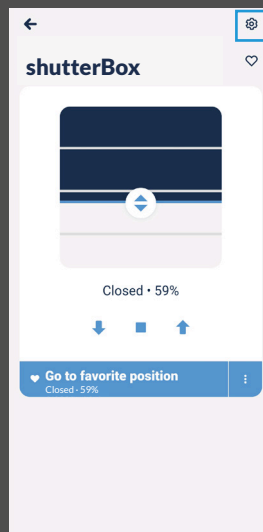

Move on to the "Access point" section.

[Step \(11/12\)](#)

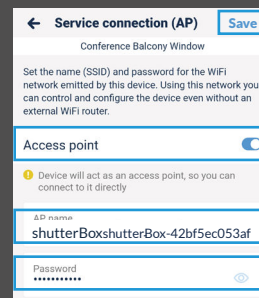

Remember to tap "save" button.

You can turn off access point here to prevent unauthorized access...

[Step \(12/12\)](#)

... or you can set the password for the device AP to prevent unauthorized access.

[Step \(12/12\)](#)

11

That's all!

For more information about your specific device, see the user guides.

Please continue below if you want to see how to share a configured device with another family member.



How to add configured BleBox device to another account

12 > Add configured controller using another smartphone

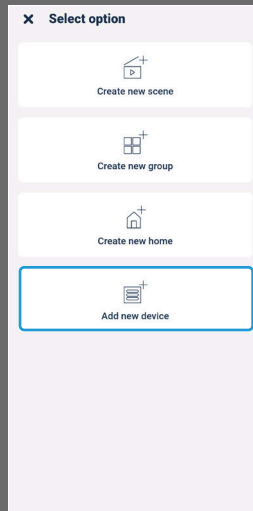
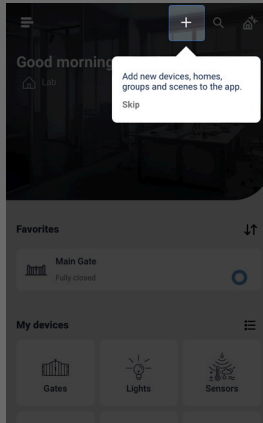

Tap on "Add devices already connected to the WiFi network".

Step (1/3)



13

Remember to tap "save" button.

Please select "Scan for devices" and wait until scan is done. Please remember that you need to be connected with the same WiFi network what BleBox controller.

Step (2/3)

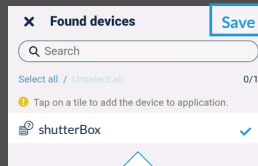
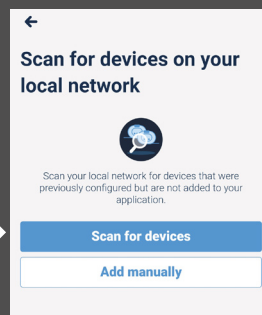

Select which device you want to add to your account.

Step (3/3)

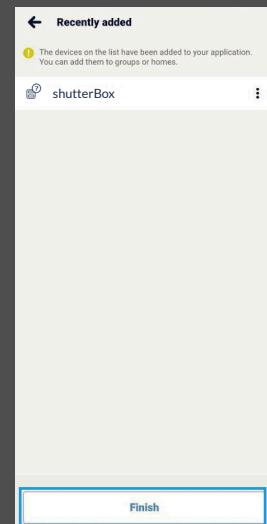

14

That's all!

You can go back to the dashboard or add controllers to specific home.

Remember!

You can also share devices via e-mail or μ Portal.

①

Use share option in μ Portal
<https://portal.blebox.eu>

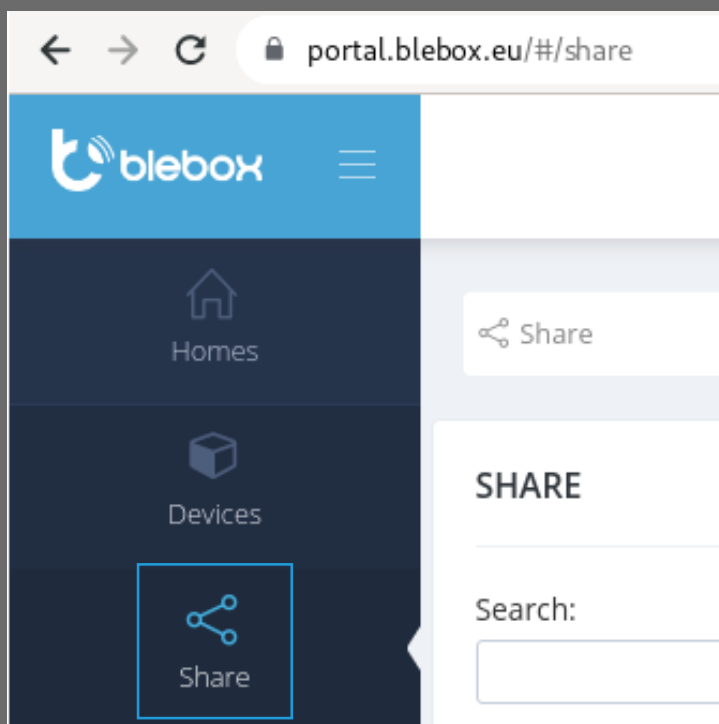

②

Use "Sharing management"
option in wBox app menu.

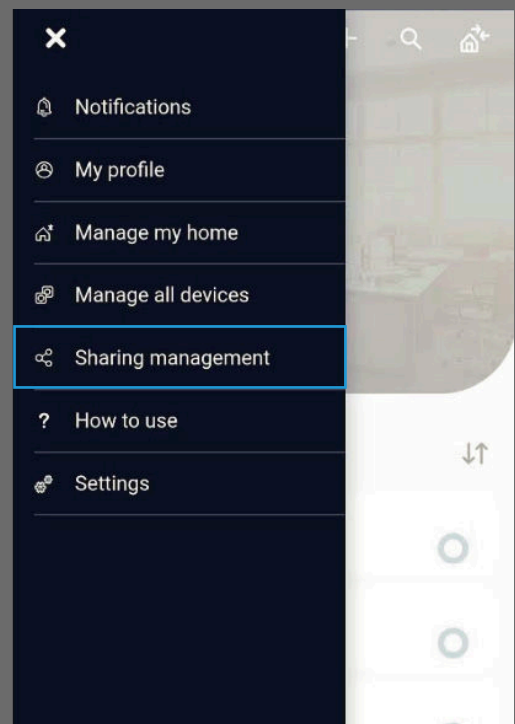

for more information visit our website

www.blebox.eu

or send us an email to: info@blebox.eu
support is available at support@blebox.eu

proudly made by
blebox